

RoHS Compliant Product
A suffix of "-C" specifies halogen & lead-free

FEATURES

- Ideal for surface mount applications
- Easy pick and place
- Built-in strain relief

MECHANICAL DATA

- Case: Molded Plastic
- Epoxy: UL 94V-0 rate flame retardant
- Metallurgically bonded construction
- Polarity: Color band denotes cathode end
- Mounting position: Any

SMA

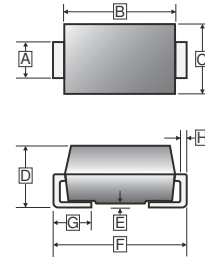
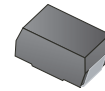

PACKAGE INFORMATION

Package	MPQ	Leader Size
SMA	5K	13 inch

REF.	Millimeter		REF.	Millimeter	
	Min.	Max.		Min.	Max.
A	1.23	1.65	E	-	0.3
B	3.99	4.75	F	4.70	5.28
C	2.30	2.90	G	0.75	1.52
D	1.90	2.62	H	0.15	0.31

ORDER INFORMATION

Part Number	Type
SK22L-C~SK24LL-C	Lead (Pb)-free and Halogen-free



MAXIMUM RATINGS AND ELECTRICAL CHARACTERISTICS

(Rating 25°C ambient temperature unless otherwise specified. Single phase half wave, 60Hz, resistive or inductive load.
For capacitive load, de-rate current by 20%.)

Parameter	Symbol	Part Number				Unit
		SK22L-C	SK22LL-C	SK24L-C	SK24LL-C	
Peak Repetitive Peak Reverse Voltage	V_{RRM}	20	20	40	40	V
Working Peak Reverse Voltage	V_{RWM}	20	20	40	40	
Maximum DC Blocking Voltage	V_R	20	20	40	40	
Average Forward Current	$I_{F(AV)}$	2				A
Peak Forward Current @8.3ms Half Sine	I_{FSM}	60				A
Maximum Instantaneous Forward Voltage @ $I_F=2A$	V_F	0.38	0.34	0.4	0.36	V
Maximum DC Reverse Current ¹ @Rated DC Blocking Voltage	$T_A=25^\circ C$	2				mA
	$T_A=80^\circ C$	40				
Thermal Resistance Junction-Ambient	$R_{\theta JA}$	55				°C/W
Thermal Resistance Junction-Case	$R_{\theta JC}$	20				°C/W
Operating & Storage Temperature Range	T_J, T_{STG}	-25~100, -50~125				°C

Note:

1. Pulse Test: Pulse Width $\leq 300\mu s$, Duty Cycle $\leq 2\%$.

RATINGS AND CHARACTERISTIC CURVES

FIG.1- Typical Forward Current Derating Curve

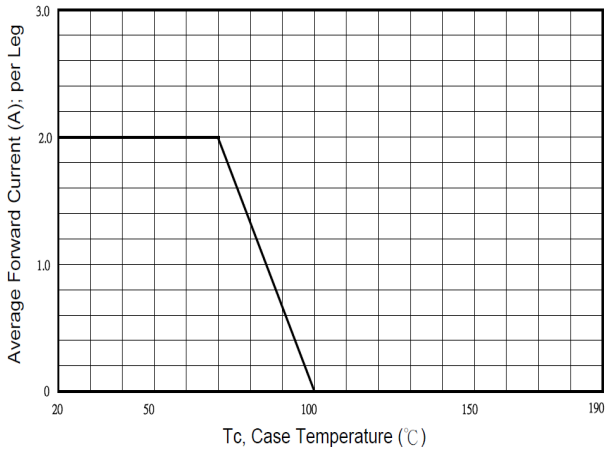

FIG.2-MAXIMUM NON-REPETITIVE FORWARD SURGE CURRENT

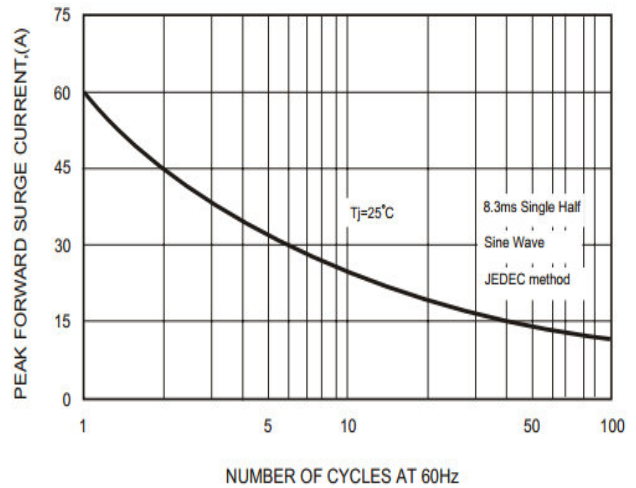

FIG.3-TYPICAL JUNCTION CAPACITANCE

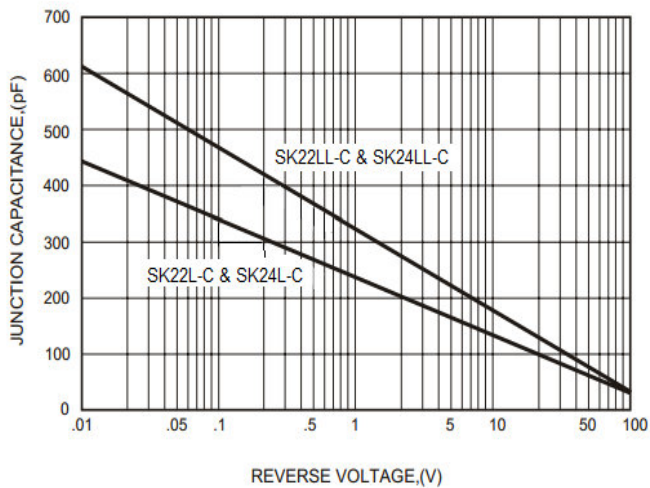

FIG.4 - TYPICAL REVERSE CHARACTERISTICS

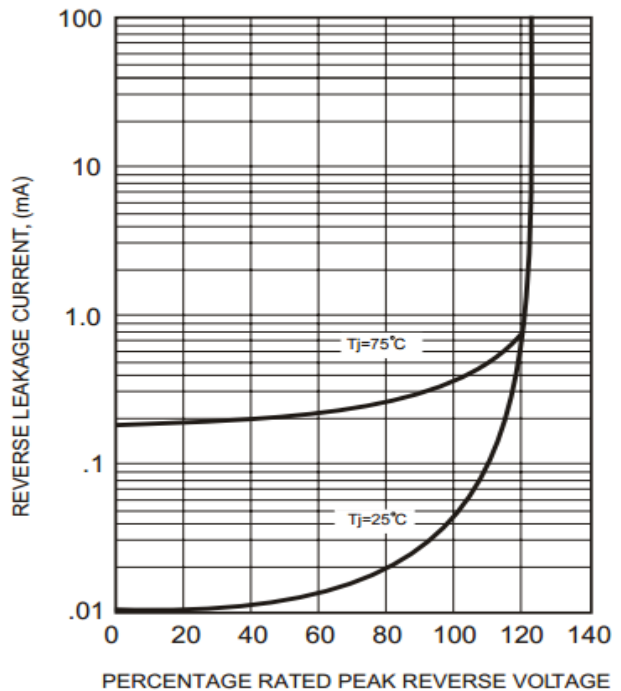
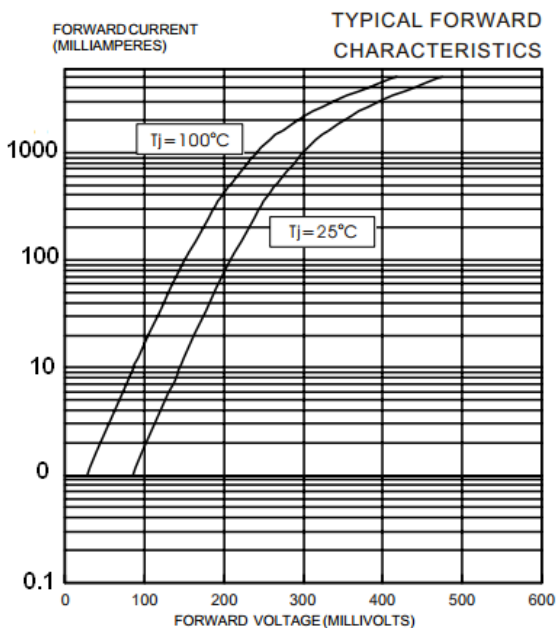

FIG. 5 (For SK22L-C)



RATINGS AND CHARACTERISTIC CURVES

FIG. 6 (For SK22LL-C)

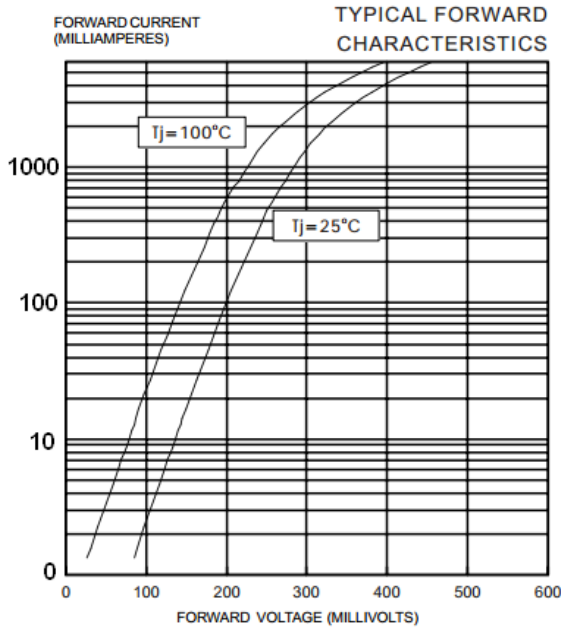

FIG. 7 (For SK24L-C)

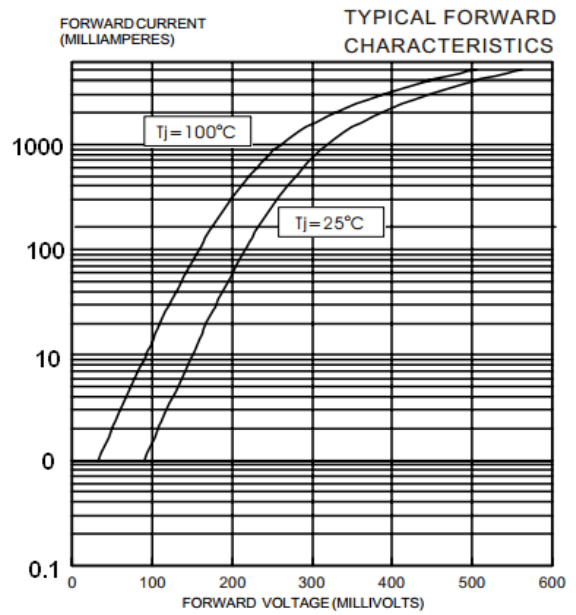

FIG. 8 (For SK24LL-C)

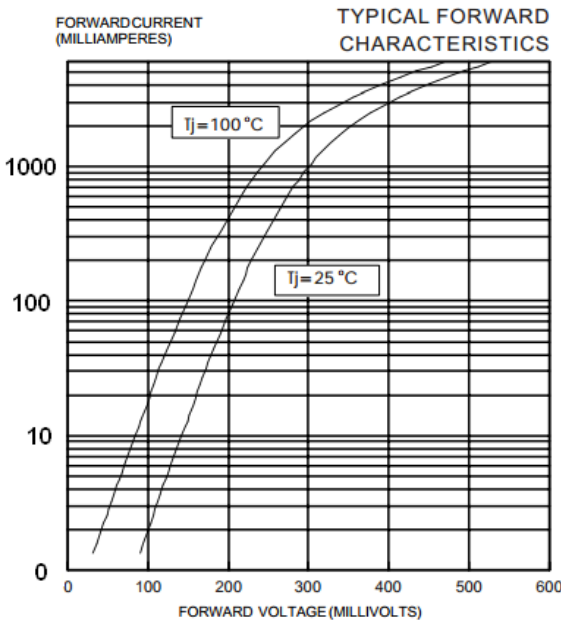

FIG. 9- Mounting Pad Layout

